

Multifan

System-1

The Multifan System 1 is complete ventilation unit consisting of a Multifan Panel fan, wireguard, shutter and plastic casing. With the simple click system, the fan, wireguard and casing can be installed easily. Weather influences (wind, rain) are reduced to a minimum. Especially at the minimum ventilation, the system guarantees an accurate ventilation level. The Multifan System-1 enables a long life cycle with minimal maintenance.



Features:

- “Flush-mount” installation
- Protects against weather influences
- Compact system: fan, wire guard shutter and hood
- No obstacles inside the building
- High temperature bearings
- All parts can be recycled
- Water resistant (IP55)
- Rated for washdown
- Available in single phase, three phase 120/240/460 V
- Corrosion resistant

Advantages:

- Low power consumption
- Long durability
- High reliability
- Low maintenance
- Easy to install
- Easy cleaning
- Suitable for different applications
- Safe in use
- Low noise level
- 3 year warranty on the motor



Technical information

	Partnumber	Type	Ø impeller (inch)	RPM	I _{nom} (A)	P _{in} (W)	CFM				Controllability**
							at 0" SP	at 0.12" SP	at 0.20" SP	at 0.32" SP	
1~240 V 60 Hz	S1102E2A*	S1E25	10	3200	1 / 1.3	220	1250				E/T
	S1104E2A*	S1E25	10	1600	0.4	70	880	660			E/T
	S1124E2/Q	S1E30	12	1680	0.5	110	1400	1300	1200		E/T
	S1122E2AQ	S1E30	12	3200	1.5	350	2200	2050	1950	1850	E/T
	S1124E2A/Q	S1E30	12	1680	0.5	110	1400	1300	1200		E/T
	S1144E2A/Q	S1E35	14	1645	0.9	180	2150	1950	1800	1500	E/T
	S1164E2A/Q	S1E40	16	1635	1.1	260	3000	2750	2600	2300	E/T
	S1184E2A/Q	S1E45	18	1640	1.4	310	3800	3500	3300	2850	E/T
	S1204E2A/Q	S1E50	20	1580	1.8	430	4900	4500	4250	3750	E/T
	S1246EQ2A	S1E63	24	1100	2.8	660	7100	6650	6300	5700	E/T
	S1244E2AQ	S1E63	24	1650	7.4	1700	10400	9950	9700	9250	None
1~120 V 60 Hz	S1104E1A*	S1E25	10	1710	1.0	70	820	680			E/T
	S1124E1AQ	S1E30	12	1655	1.0	100	1300	1200	1100		E/T
	S1144E1AQ	S1E35	14	1600	1.8	165	2150	2000	1850	1650	E/T
	S1164E1/Q	S1E40	16	1635	2.2	250	2950	2550	2150		E/T
	S1184E1A/Q	S1E45	18	1600	3	330	3750	3450	3150		E/T
	S1204E1A/Q	S1E50	20	1600	3.3	410	4900	4450	4200	3700	E/T
	S1245E1A/Q	S1E63	24	1000	6.7	650	6900		5550		E/T

(*) 10" fans are not available in Q-style

(**) Controllable Electronically (E) or by Transformer (T)

Fans tested by Bess Laboratory - Department of Agriculture engineering, University of Illinois

Fans tested with hood, shutter and grill in place.

Fans are UL, CSA, AMCA and DLG approved

Dimensions

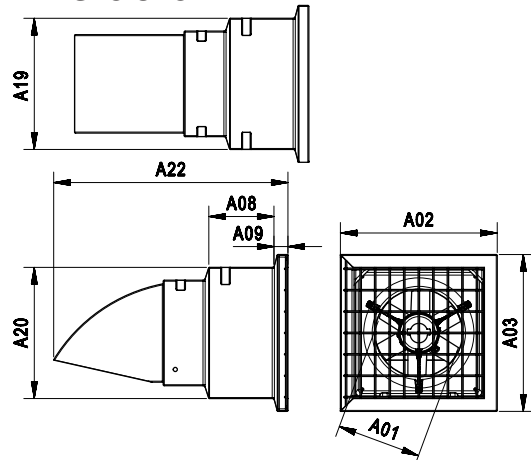

Ø inch	Dimensions (inch)							
	A01	A02	A03	A08	A09	A19	A20	A22
12	12.3	21.7	21.7	9.0	1.9	18.1	18.1	32.4
16	16.3	25.0	25.0	8.6	2.2	22.0	22.0	35.0
18	18.1	27.4	27.4	9.5	2.3	24.0	24.0	37.0
20	20.2	29.0	29.0	9.1	2.2	26.0	26.0	39.6
24	25.4	34.4	34.4	10.6	2.0	31.5	31.5	46.5



Vostermans Ventilation B.V.
P.O. Box 3025
NL-5902 RA Venlo – Holland
Tel. +31 (0)77 389 32 32
Fax +31 (0)77 382 08 93
ventilation@vostermans.com
www.vostermans.com

Vostermans Ventilation S.A.R.L.
B.P. 1801
27018 Evreux Cedex
France
Tel. +33 (0)2 32 38 11 00
Fax +33 (0)2 32 33 37 12
ventilation@vostermansfrance.com
www.vostermans.com

All rights reserved. Vostermans Companies is not responsible for inaccurate or incomplete data. In case of questions and / or regards, please contact ventilation@vostermans.com

Vostermans Ventilation Inc.
2439 S.Main St. – USA
Bloomington, IL 61704
Tel. +1 309 827 - 9798
Fax +1 309 829 - 1993
ventilation@vostermansusa.com
www.vostermansusa.com

Vostermans Ventilation Sdn. Bhd.
330, Lot 2593, Jln Seruling 59, Kws3,
Tmn Klang Jaya, 41200, Klang,
Selangor D.E., Malaysia
Tel. +60 (0)33324 3638 (HL)
Fax +60 (0)33324 1239
ventilation@vostermansasia.com
www.vostermans.com

Vostermans Ventilation B.V. develops, manufactures and distributes the full line of:

